

**EXHIBIT "F"**  
**FIELD NOTE DESCRIPTION**  
**OF A 0.0138 ACRE TRACT OF LAND SITUATED IN THE**  
**WILLIAM LARNER SURVEY, ABSTRACT NO. 799**  
**CITY OF CARROLLTON, DALLAS COUNTY, TEXAS**

BEING A 0.0138 ACRE (600 SQUARE FEET) TRACT OF LAND SITUATED IN THE WILLIAM LARNER SURVEY, ABSTRACT NUMBER 799, CITY OF CARROLLTON, DALLAS COUNTY, TEXAS, AND BEING A PORTION OF A 20-FOOT ALLEY DEDICATED BY D.C. PERRY'S ADDITION, AN ADDITION TO THE CITY OF CARROLLTON ACCORDING TO THE PLAT THEREOF RECORDED IN VOLUME 274, PAGE 75, MAP RECORDS OF DALLAS COUNTY, TEXAS, (M.R.D.C.T.); SAID 0.0138 ACRE TRACT OF LAND BEING MORE PARTICULARLY DESCRIBED AS FOLLOWS:

**COMMENCING** AT A 1/2-INCH IRON ROD WITH PLASTIC CAP STAMPED "BW2" FOUND FOR THE NORTHEAST CORNER OF THE REMAINDER OF LOT 16, BLOCK A OF SAID D.C. PERRY'S ADDITION, SAME BEING THE NORTHWEST CORNER OF THE REMAINDER OF LOT 15, BLOCK A OF SAID D.C. PERRY'S ADDITION, AND BEING IN THE SOUTH RIGHT-OF-WAY LINE OF BELTLINE ROAD, (VARIABLE WIDTH RIGHT-OF-WAY);

**THENCE**, SOUTH 00°11'46" WEST, ALONG THE COMMON LINE OF SAID LOT 15, BLOCK A AND SAID LOT 16, BLOCK A, A DISTANCE OF 105.50 FEET TO THE POINT OF BEGINNING BEING THE SOUTHWEST CORNER OF SAID LOT 15, BLOCK A, SAME BEING THE SOUTHEAST CORNER OF SAID LOT 16, BLOCK A, BEING IN THE NORTH LINE OF SAID 20-FOOT ALLEY, AND FROM WHICH A 1/2-INCH IRON ROD WITH PLASTIC CAP STAMPED "BW2" FOUND FOR THE NORTHEAST CORNER OF LOT 7, BLOCK A OF SAID D.C. PERRY'S ADDITION, SAME BEING THE NORTHWEST CORNER OF LOT 8, BLOCK A OF SAID D.C. PERRY'S ADDITION, BEARS SOUTH 00°11'46" WEST, A DISTANCE OF 20.00 FEET;

**THENCE**, SOUTH 89°48'14" EAST, ALONG THE COMMON LINE OF SAID 20-FOOT ALLEY AND SAID LOT 15, BLOCK A, A DISTANCE OF 60.00 FEET TO A POINT FOR THE SOUTHEAST CORNER OF SAID LOT 15, BLOCK A, SAME BEING THE SOUTHWEST CORNER OF THE REMAINDER OF LOT 1, BLOCK A OF NEIGHBORHOOD SERVICE CENTER, AN ADDITION TO THE CITY OF CARROLLTON, ACCORDING TO THE PLAT THEREOF RECORDED IN VOLUME 86054, PAGE 1060, DEED RECORDS OF DALLAS COUNTY, TEXAS, (D.R.D.C.T.);

**THENCE**, DEPARTING SAID COMMON LINE OVER AND ACROSS SAID 20-FOOT ALLEY THE FOLLOWING CALLS:

SOUTH 00°11'46" WEST, A DISTANCE OF 10.00 FEET TO A POINT FOR CORNER;

NORTH 89°48'14" WEST, A DISTANCE OF 60.00 FEET TO A POINT FOR CORNER;

NORTH 00°11'46" EAST, A DISTANCE OF 10.00 FEET TO THE POINT OF BEGINNING CONTAINING A COMPUTED AREA OF 600 SQUARE FEET OR 0.0138 ACRES OF LAND.

**NOTES:**

A SKETCH WAS PREPARED ON EVEN DATE TO ACCOMPANY THIS DESCRIPTION.

THE BEARINGS CALLED FOR HEREIN ARE REFERENCED TO THE TEXAS STATE PLANE COORDINATE SYSTEM (NORTH CENTRAL ZONE, NAD 83) BASED ON LEICA GERO SYSTEMS NORTH TEXAS SMARTNET NETWORK, DISTANCES ADJUSTED TO SURFACE USING AN AVERAGE COMBINED SCALE FACTOR OF 0.99985686993.



JOSHUA B. LEE SURVEY  
ABSTRACT NO. 798

WILLIAM LARNER SURVEY  
ABSTRACT NO. 799

**BELT LINE ROAD**  
(VARIABLE WIDTH R.O.W.)

APPROXIMATE LOCATION OF SURVEY LINE  
ORIGINAL CENTERLINE OF BELT LINE RD.

CALLED 1,337 SQ. FT.  
PARCEL 12-S  
CITY OF CARROLLTON  
VOL. 99116, PG. 4595  
D.R.D.C.T.

CALLED 1,820 SQ. FT.  
PARCEL 11-S  
CITY OF CARROLLTON  
VOL. 97147, PG. 6065  
D.R.D.C.T.

CALLED 1,080 SQ. FT.  
PARCEL 10-S  
CITY OF CARROLLTON  
VOL. 97061, PG. 694  
D.R.D.C.T.



J.B. LESLEY'S ADDITION  
VOL. 5, PG. 377  
D.R.D.C.T.

20' ALLEY  
VOL. 5, PG. 377, D.R.D.C.T.

**LEGEND**

- CIRF CAPPED IRON ROD FOUND
- D.R.D.C.T. DEED RECORDS OF DALLAS COUNTY, TEXAS
- O.P.R.D.C.T. OFFICIAL PUBLIC RECORDS OF DALLAS COUNTY, TEXAS
- M.R.D.C.T. MAP RECORDS OF DALLAS COUNTY, TEXAS
- VOL., PG. VOLUME, PAGE
- INST., NO. INSTRUMENT, NUMBER
- R.O.W. RIGHT-OF-WAY
- (CM) CONTROLLING MONUMENT
- POC POINT OF COMMENCING
- POB POINT OF BEGINNING

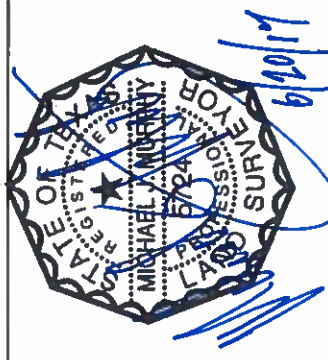

MICHAEL J. MURPHY  
REGISTERED PROFESSIONAL  
LAND SURVEYOR NO. 5724

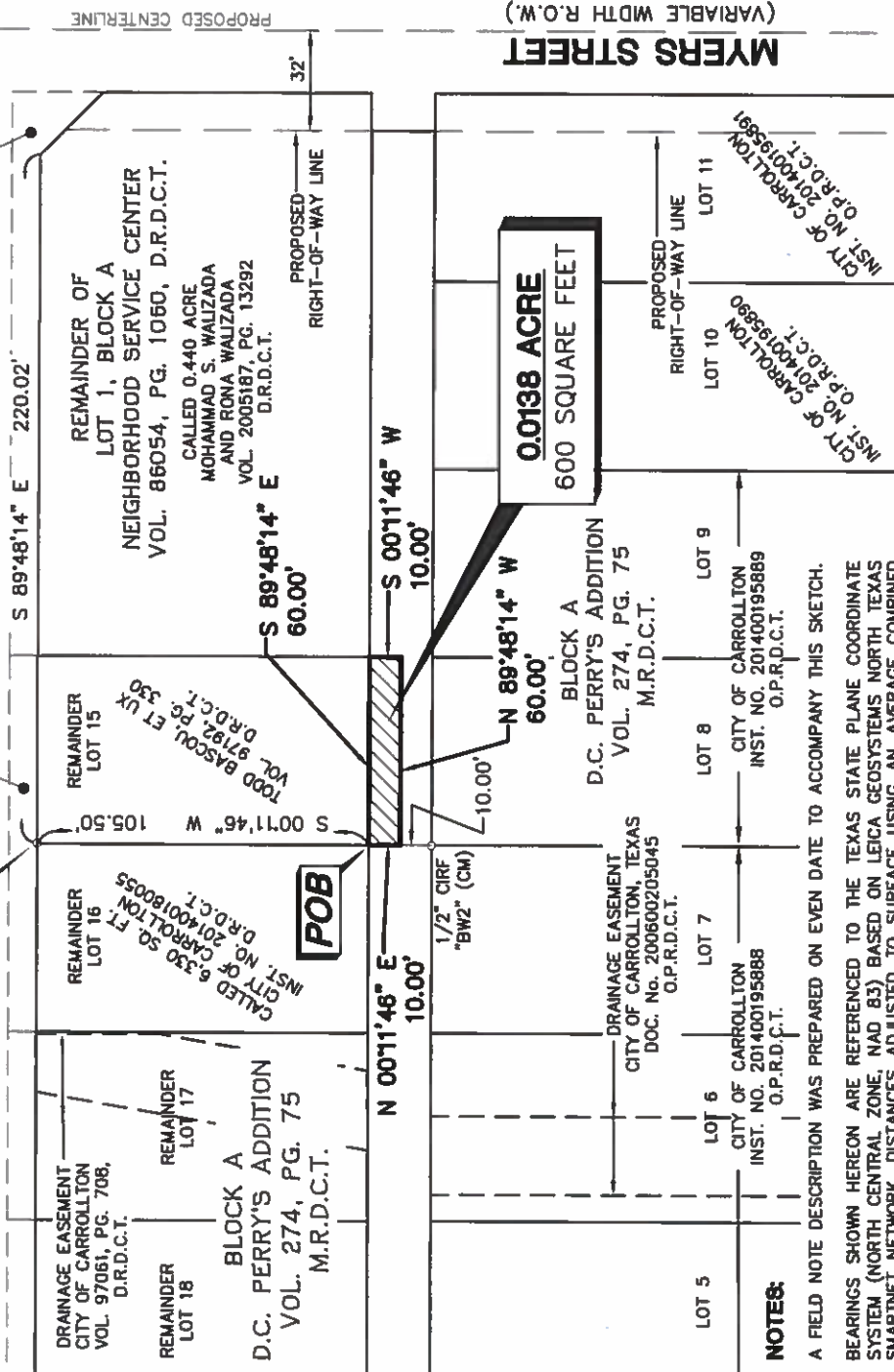

MYERS STREET  
(VARIABLE WIDTH R.O.W.)

**POC**  
1/2" CIRF "BW2" (CM)

**POB**

**NOTES:**

A FIELD NOTE DESCRIPTION WAS PREPARED ON EVEN DATE TO ACCOMPANY THIS SKETCH.  
BEARINGS SHOWN HEREON ARE REFERENCED TO THE TEXAS STATE PLANE COORDINATE SYSTEM (NORTH CENTRAL ZONE, NAD 83) BASED ON LEICA GEOSYSTEMS NORTH TEXAS SMARTNET NETWORK. DISTANCES ADJUSTED TO SURFACE USING AN AVERAGE COMBINED SCALE FACTOR OF 0.99985686993.

12222 Merit Tower, Suite 400  
Dallas, Texas 75251  
Tel. (972) 991-0011  
TBPE # F-6324 TBPLS # 10194229  
Copyright © 2017

**EXHIBIT 'F'**  
**0.0138 ACRE TRACT OF LAND SITUATED IN THE**  
**SITUATED IN WILLIAM LARNER SURVEY, ABSTRACT NO. 799**  
**CITY OF CARROLLTON, DALLAS COUNTY, TEXAS**